



Build A Responsive Time Tracking App :

With The Power Platform

Speaker: Paul Papanek Stork, MVP

Paul Papanek Stork



Owner/Principal
Architect



Don't Pa..Panic
Consulting

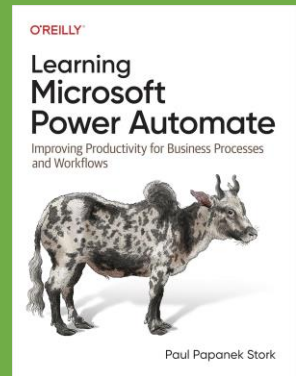

Available Now!



Power Platform
Community
Contributor

Super User in...

- Power Apps
- Power Automate
- Power Virtual Agent

Contact
Information

Email:
pstork@dontpapanic.com

Blog:
dontPaPanic.com/blog

Twitter:
[@PSStork](https://twitter.com/PSStork)



Power Platform Forum
Triple Super User



Agenda

Getting Started

Planning & Preparation

Building a Responsive Menu Component

Creating a Responsive App UI

Implementing Time Tracking

Planning

- What form factors or devices do you want to support.
 - PC/Tablet (Large) vs Mobile (Small)
 - Portrait vs Landscape
- Does the app behave different in some form factors?
 - Do the element layouts change
 - Are elements hidden in some layouts/sizes



Key Display Settings

- Portrait or Landscape Orientation
- Screen Size (Tablet only)
 - 16:9 Default
 - 3:2 Surface Pro 3
 - 16:10 Widescreen
 - 4:3 iPad
 - Custom
- Disable Scale to fit
 - Lock Aspect ratio disabled
- Lock Orientation?

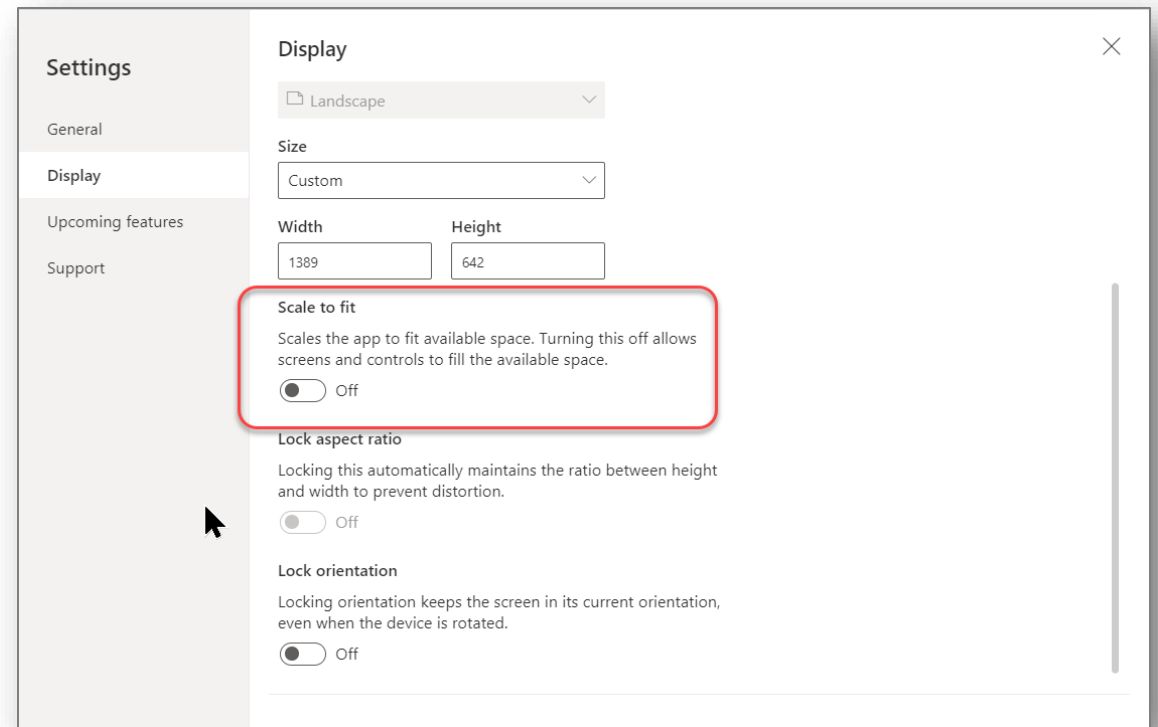

Key App Settings

- App Size Breakpoints
 - Small (1), Medium (2), Large (3), ExtraLarge (4)
 - Tablet – [600, 900, 1200]
 - Phone - [1200, 1800, 2400]
- DesignWidth & DesignHeight – Adjustable in Settings
- MinScreenWidth & MinScreenHeight – Adjustable in App

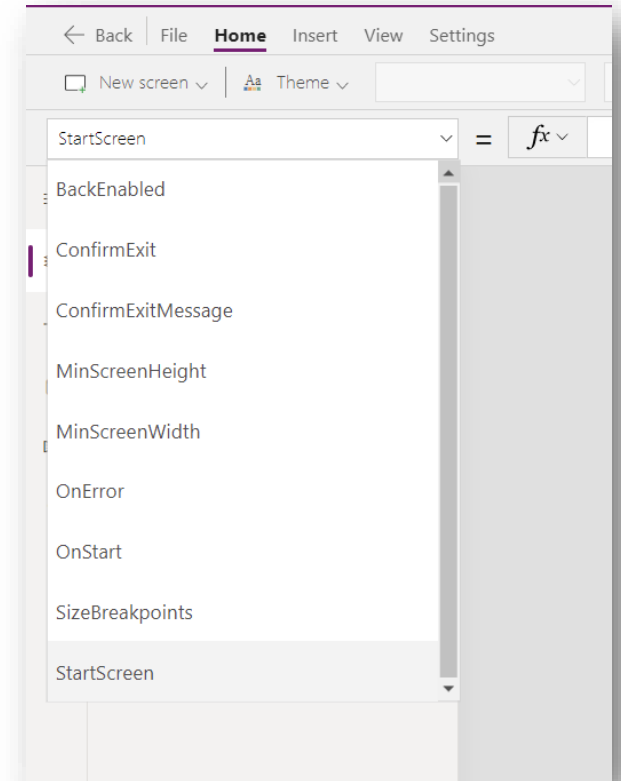

Preparation & Planning

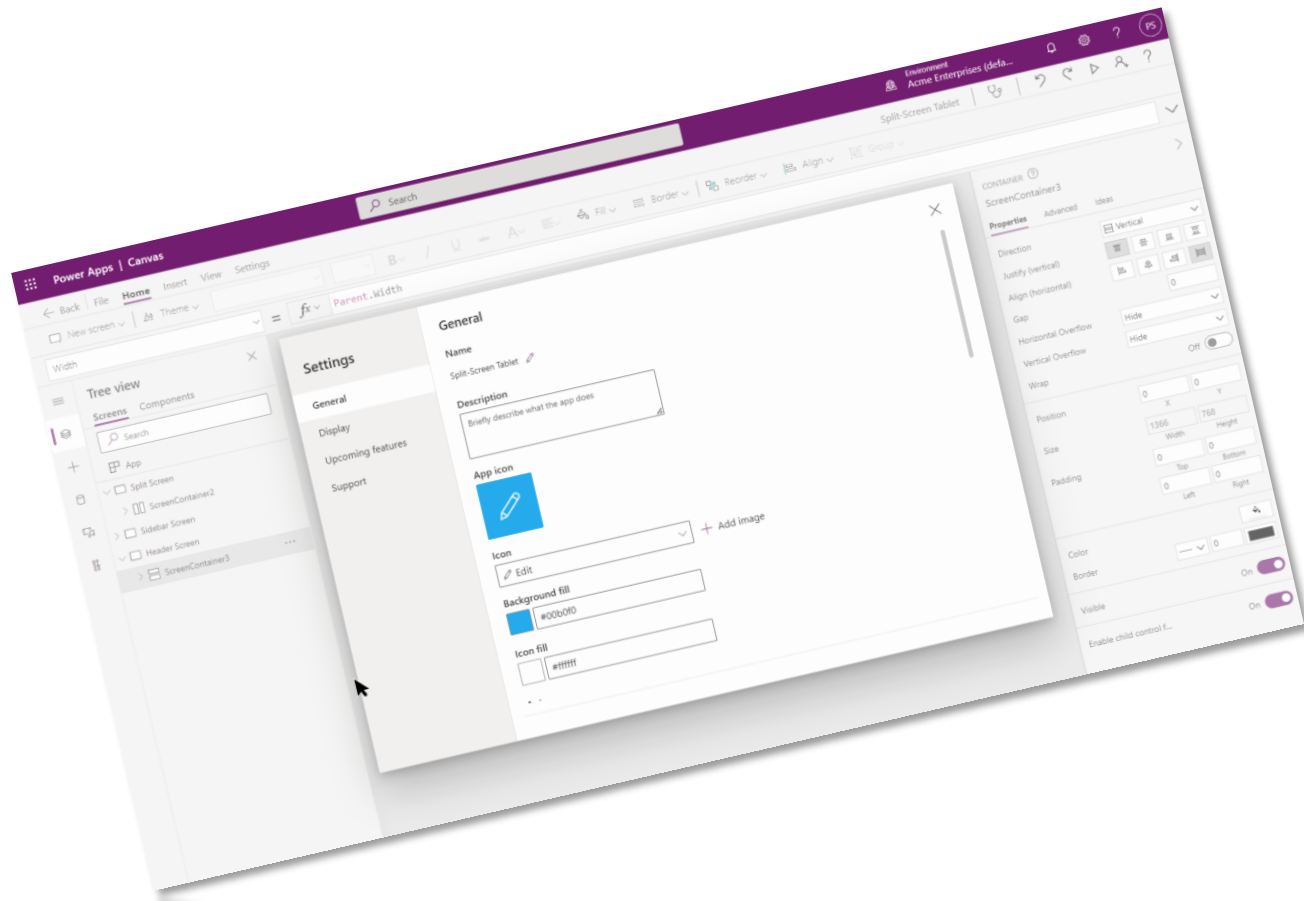

demo

Relative Placement/Sizing

- Standard Container – Not Horizontal/Vertical
- X, Y Location relative to Upper Left Corner of Container
- Width/Height calculated based on Parent.Width and Parent.Height
- Establish Location/Size of one Control and make others relative to it
- Scale/Hide items based on Size Breakpoints

Container

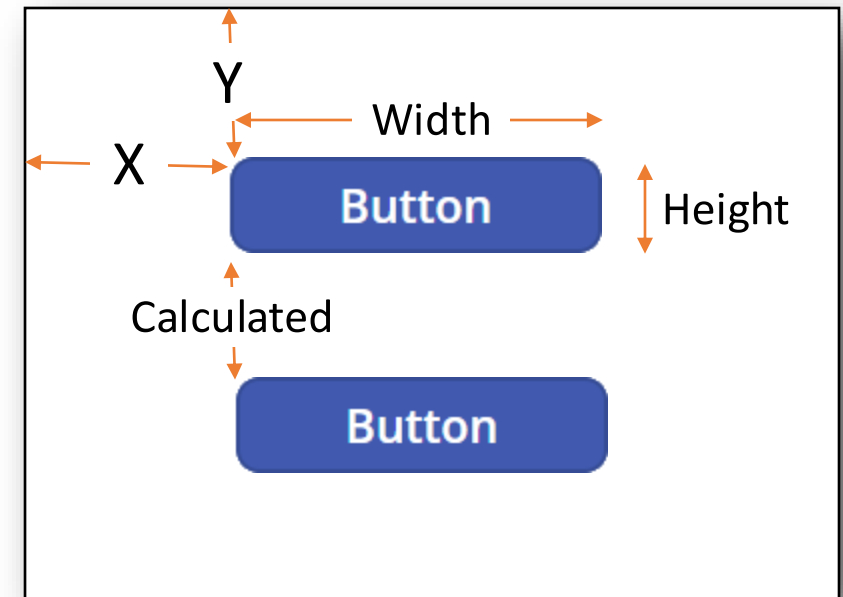

Creating Reusable Components

- Create a Component Library
- Create needed Input/Output Properties
- Build the Component
- Test the Component
- Load into an App

Building a Responsive Menu Component

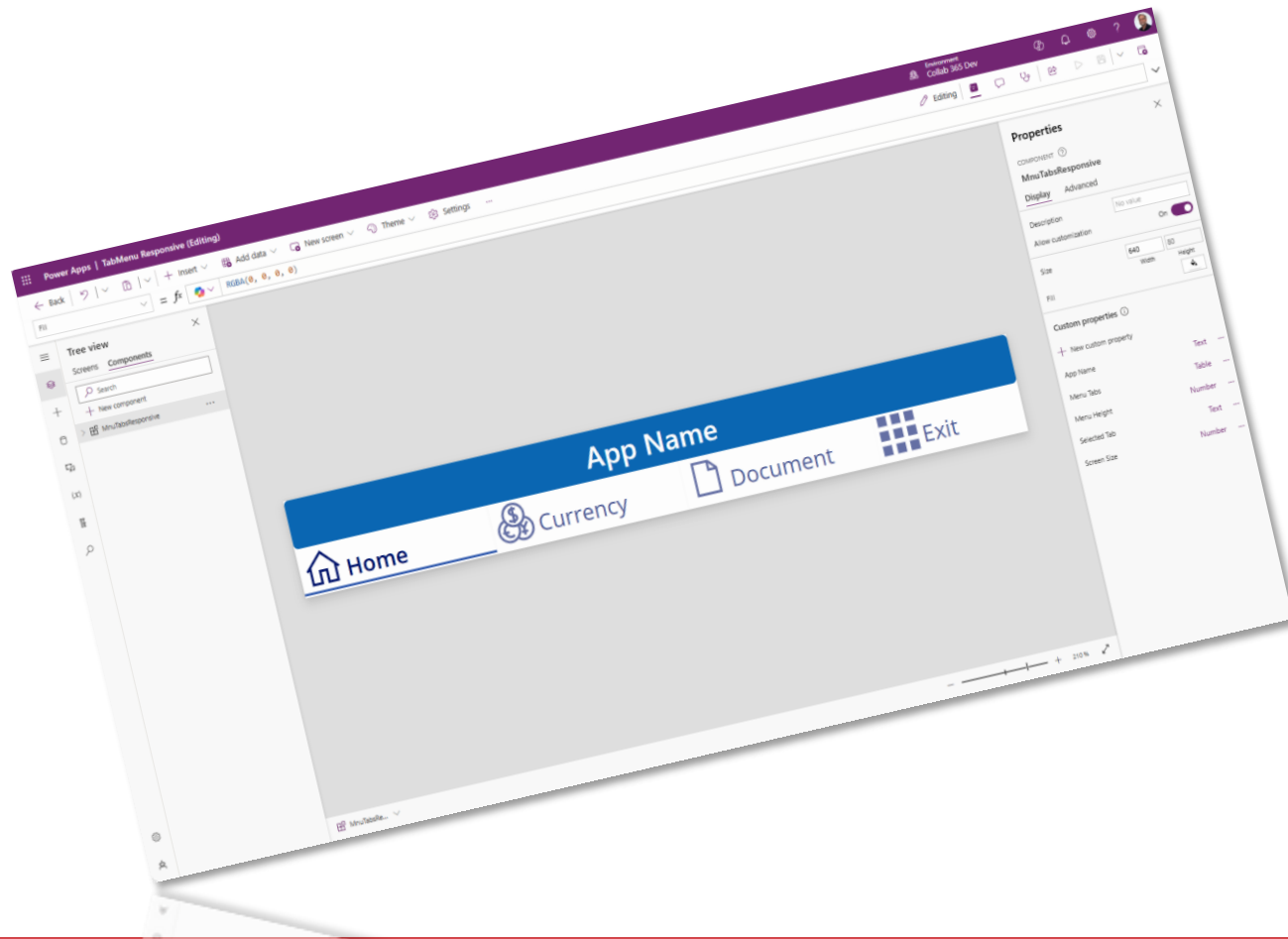

demo



Breaktime

Hierarchical Layout Controls

- Auto-Layout Containers, Galleries, and Forms
 - Horizontal or Vertical
 - Automatic flowed alignment
- Fixed-Layout Containers
 - Relative X, Y, Width, & Height based on Parent
- Pre-built Layouts using Containers for Tablets only
 - Split-screen
 - Sidebar
 - Header, main section, footer

Containers – Key Properties

- Layout Direction – Vertical or Horizontal
- Justify/Align – Left/Top, Center, Right/Bottom, Justified
- Gap – Space between Controls
- Wrap – Controls automatically Wrap around at full width
- Enable Child Control Focus – Enable/Disable Tab Stops
- Containers in Containers
 - Flexible Width – Container resizes automatically
 - Fill Portions – Relative Size (x of N total)

Galleries and Forms – Key Properties

- Galleries
 - Template Size (Height for Vertical & Width for Horizontal)
 - LayoutMinWidth & LayoutMinHeight
 - Template Padding
- Forms
 - Snap to columns
 - Columns

Building a Responsive UI

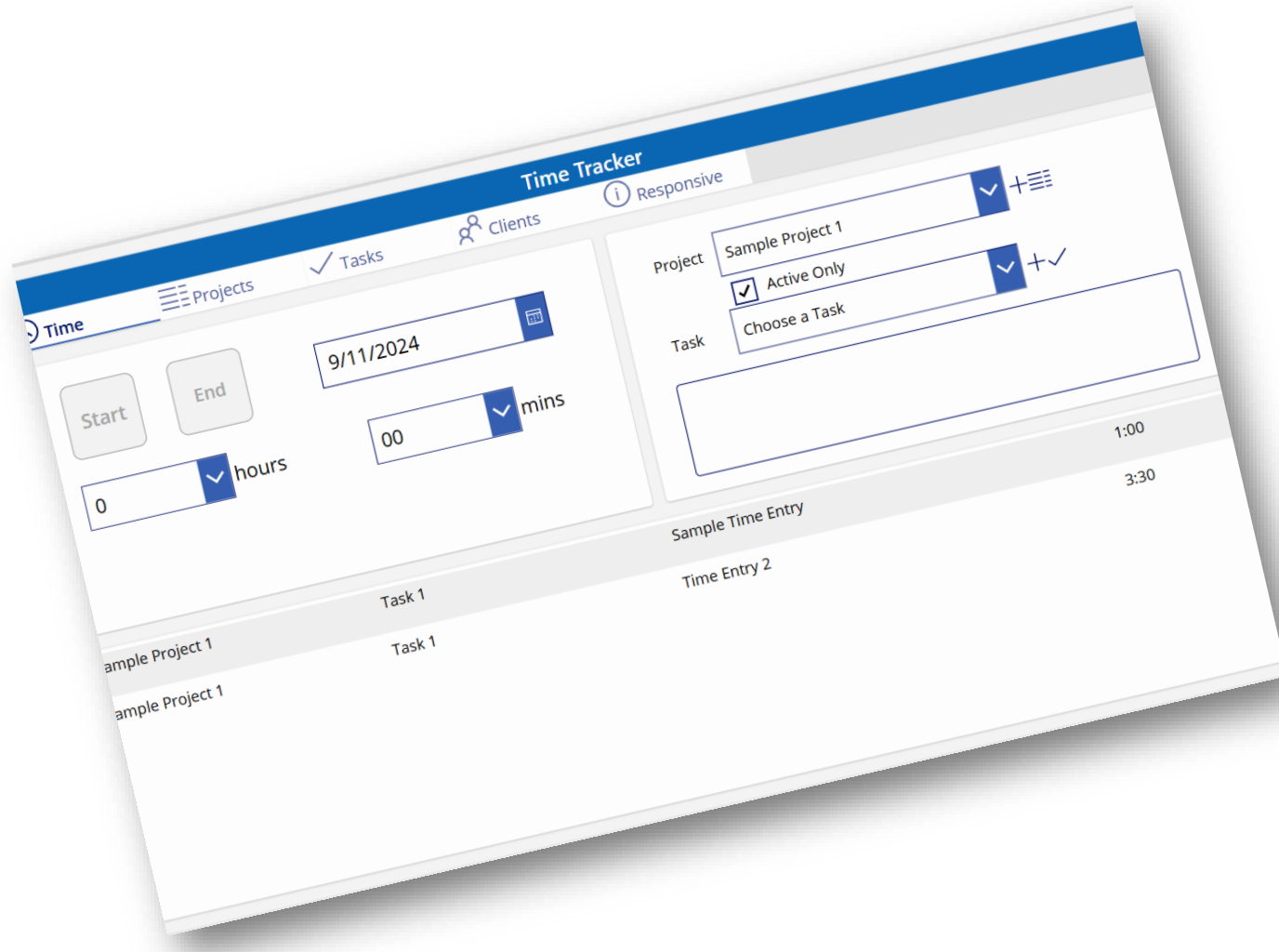

demo

Troubleshooting

- Data Table can't be nested in Container
- Always work from the Outside In
- Never Drag and Drop to Move/Resize
- Some Properties are ignored in Certain Circumstances
 - Example: Align is ignored when Wrap is set
 - Example: X, Y meaningless in Auto Layout container



Implementing Time Tracking

- Two Ways
 - Automatic – Start and End Button
 - Store Current Time in a Variable
 - Patch to Data Source on End
 - Manual – Hours and Minutes Dropdown
 - Patch to Data Source on Save
- Disable until a Project and Task are Chosen



How to Track Time

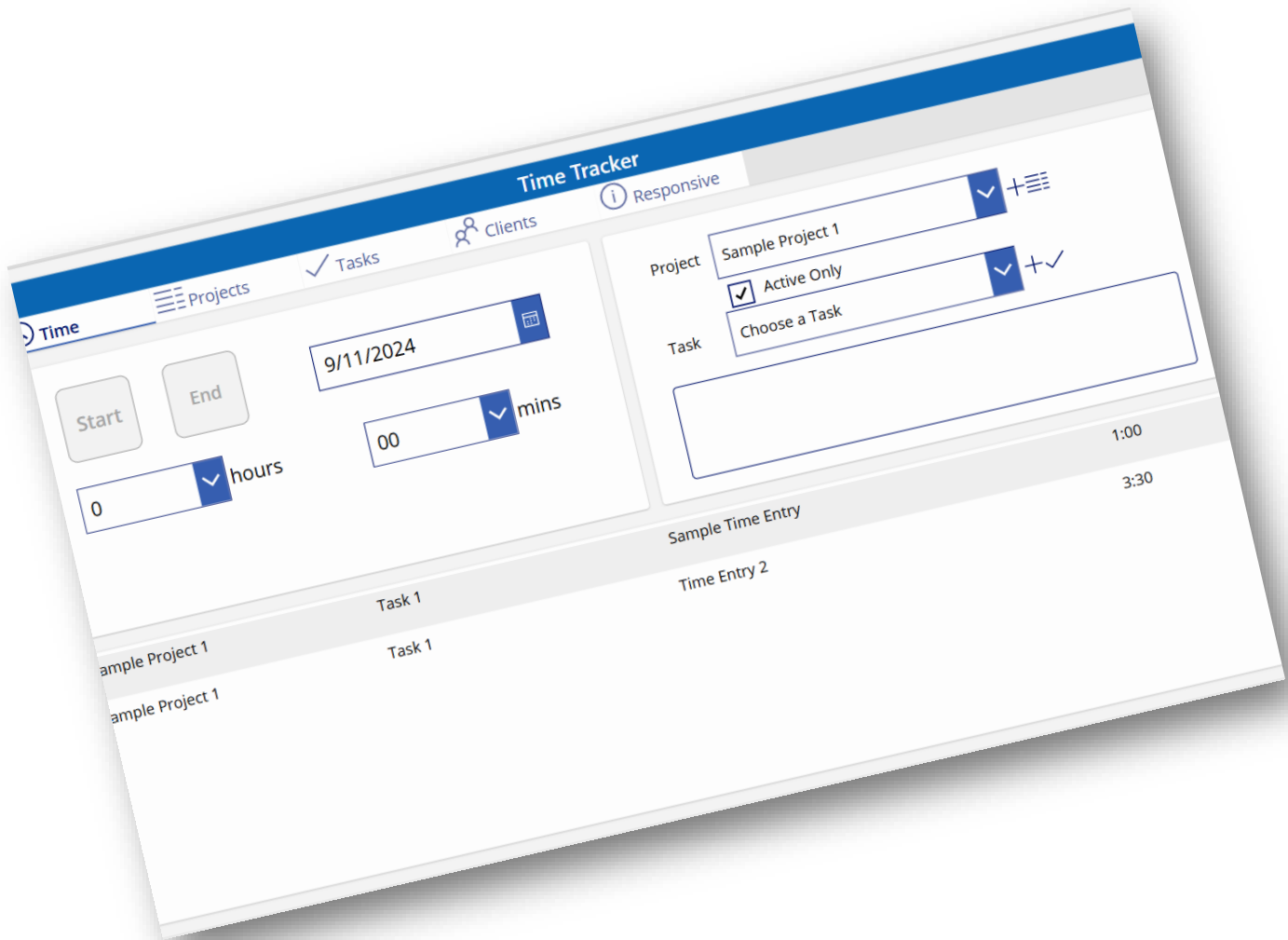

demo

Questions?

Paul Papanek Stork - MCSM, MVP
Owner\Principal Architect



**Don't Pa..Panic
Consulting**

Email: pstork@dontpapanic.com
Cell: 216.272.0573
Web: <https://dontpapanic.com>
Twitter: @PStork



**Please Remember to Fill out
Your Evaluation!!!**